

A $1\frac{1}{4}$ " x $\frac{9}{16}$ " notch needs to be created into the floor. This allows the ADA sill to sit on the finished surface. This Drawing does not take into account: pans, membranes & sealant provided by others. The ADA sill are not able to withstand air & water intrusion like the weather resistant sill. This option has no weep or drainage incorporated into the track, therefore overhang and protection is important when using this sill. It is important that you include a mop zone adjacent to these doors when choosing this option. Sweep (included) is field applied.

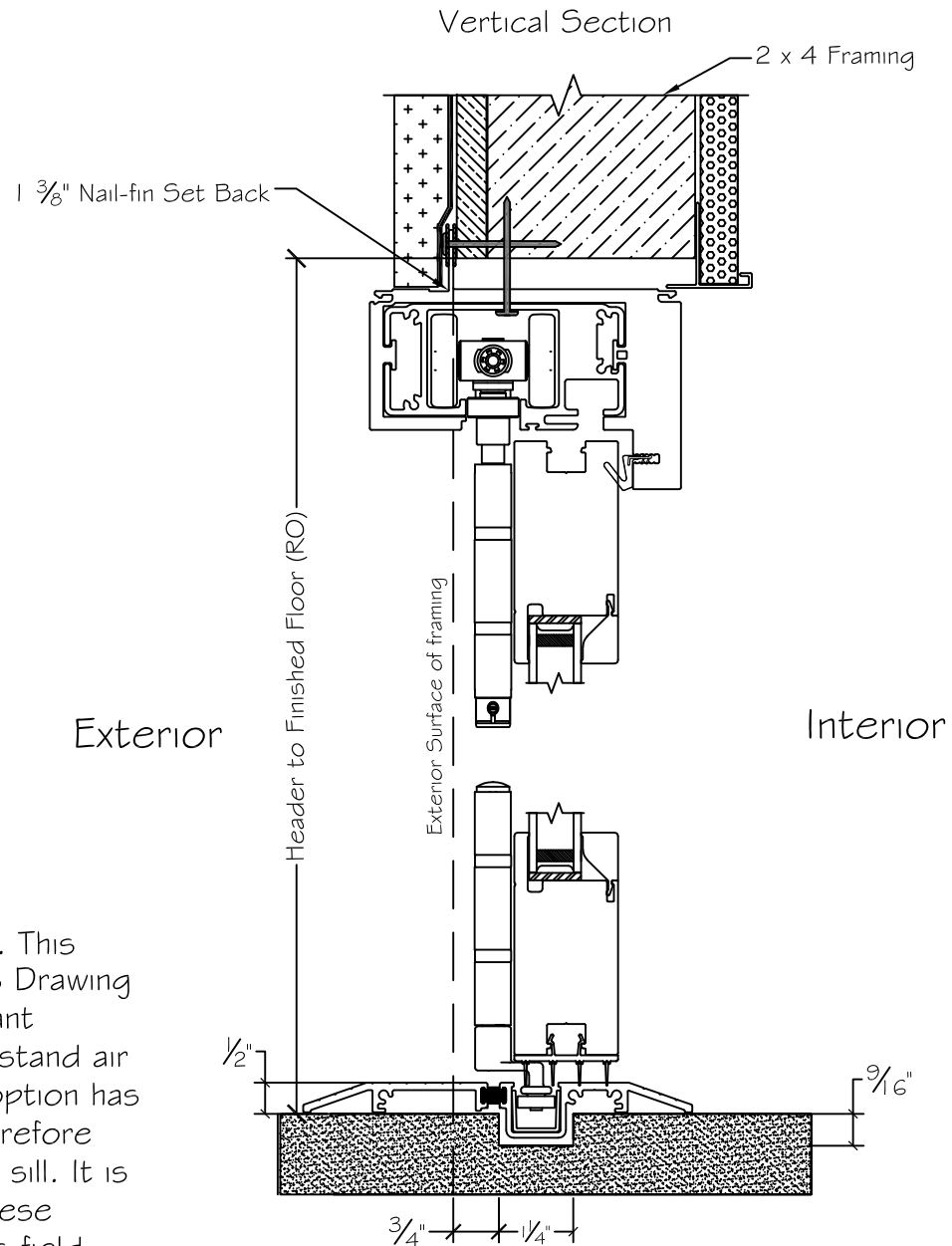

The exterior edge of the $1\frac{1}{4}$ " groove is $\frac{3}{4}$ " from the exterior edge of the framing.

450 Delta Ave
Brea, Ca 92821
(714) 385-1202



Notice: This document contains information proprietary to and is protected by copyright of Win-Dor Inc. and shall not be copied, disclosed to others, or used for any purpose other than that for which it is given, without the written permission of Win-Dor Inc.

Project:	File name: 3750 Folding Door Wall Detail - 1.375 inch Nail-fin - ADA Sill	Date: 20190206
Notes:	Layout: 3750 Folding Door with ADA Sill	Drawn by: J Johnson